

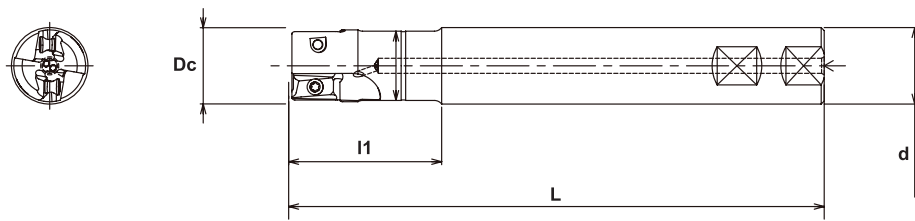

Extreme SAP Cutters

INCH
METRIC

End Mills EXSAP type



Specifications - Inch

CATALOG NUMBER	STK	DIMENSIONS				INSERT	Q	PARTS	
		Dc	L	L1	d			Screw	Wrench
EXSAP-2100-2.0-S100LG	•	1.00	7.00	2.00	1.00	ZNGU1709**ZER-PM	2	TSW-410H	T-15
EXSAP-2100-3.0-S100LG	•	1.00	8.00	3.00	1.00		2		
EXSAP-3125-3.0-S125LG	•	1.25	5.50	3.00	1.25		3		
EXSAP-3125-4.75-S125LG	•	1.25	8.00	4.75	1.25		3		
EXSAP-4150-3.0-S125LG	•	1.50	5.50	3.00	1.25		4		
EXSAP-4150-4.75-S125LG	•	1.50	8.00	4.75	1.25		4		

Note: All cutters are supplied without inserts, wrench or moly.

INSERTS ZNGU type

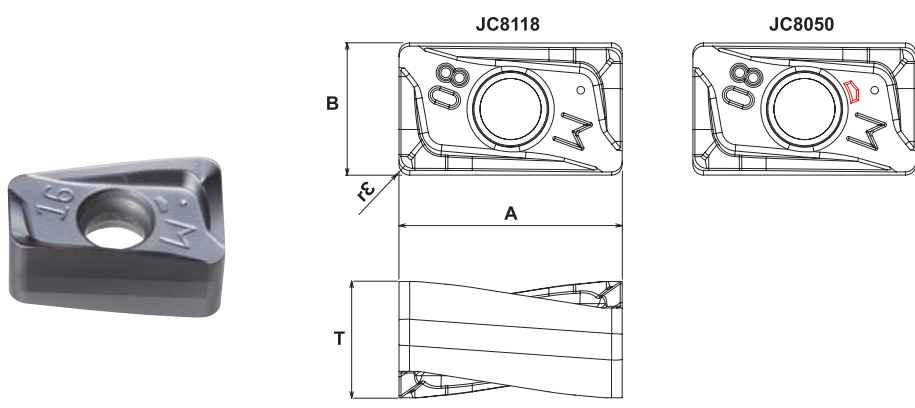

Specifications - Metric

CATALOG NUMBER	DIMENSIONS					PVD Coated	
	TOLERANCE	A	B	T	rE	JC8050	JC8118
ZNGU170908ZER-PM	G	16.9	10	8.8	0.8	•	•
ZNGU170916ZER-PM	G	16.9	10	8.8	1.6	•	•