



# QM Max

## *MQX Style For Finishing*



- High speed and high efficient finishing.
- Multiple insert choices - High Feed Milling, Shoulder Milling of steel & aluminum, Milling of high hardened steels, Finishing side & bottom face. See catalog A2 for High Feed and Shoulder Cutting.
- Low cutting force good for long reach applications.
- Able to machine most materials.
- G-body is a GN surface-hardening treatment on thermal resistant high strength steel giving a hardness over 65 HRC and secures insert pocket and holder against thermal deformation improving body durability.



# QM Max

**INCH**

**METRIC**

## QM Max

New Generation of High Feed Mills

QXPS Style

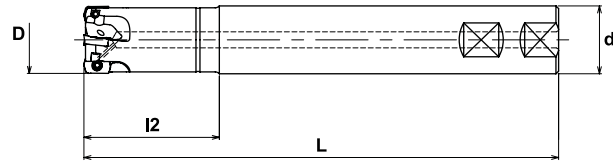

### Specifications - Inch

| CATALOG NUMBER        | STK | DIMENSIONS |      |      |      | INSERT  | Q | PARTS     |        |
|-----------------------|-----|------------|------|------|------|---|---|-----------|--------|
|                       |     | D          | L    | l2   | d    |   |   | Screw     | Wrench |
| QXPS-3075-2.0-S075NP  | •   | .750       | 5.00 | 2.00 | .750 | ZPMT1003**ZER-PL<br>ZPMT1003**ZER-NL<br>ZPMT1003**ZER-SL<br>YPHW1003**Z*R**<br>YPHW100320ZER-24 | 3 | TSW-2556H | T-08   |
| QXPS-3075-3.0-S075NP  | •   | .750       | 6.25 | 3.00 | .750 |   | 3 |           |        |
| QXPS-4100-2.0-S100NP  | •   | 1.00       | 7.00 | 2.00 | 1.00 |   | 4 | DSW-2563H | T-08   |
| QXPS-4100-3.0-S100NP  | •   | 1.00       | 8.00 | 3.00 | 1.00 |   | 4 |           |        |
| QXPS-5125-3.0-S125NP  | •   | 1.25       | 5.50 | 3.00 | 1.25 |   | 5 |           |        |
| QXPS-5125-4.75-S125NP | •   | 1.25       | 8.00 | 4.75 | 1.25 |   | 5 |           |        |
| QXPS-6150-3.0-S125NP  | •   | 1.50       | 5.50 | 3.00 | 1.50 |   | 6 |           |        |
| QXPS-6150-4.75-S125NP | •   | 1.50       | 8.00 | 4.75 | 1.50 |   | 6 |           |        |

Note: All cutters are supplied without inserts or wrenches.

## MQX Style

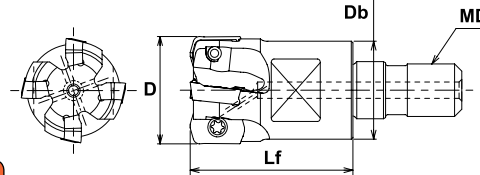

### Specifications

|        | CATALOG NUMBER | STK | DIMENSIONS |      |      |     | HEAD TORQUE |    | INSERT  | Q         | PARTS     |        |
|--------|----------------|-----|------------|------|------|-----|-------------|----|---|-----------|-----------|--------|
|        |                |     | D          | Lf   | Db   | MD  | lbs./ft     | Nm |   |           | Screw     | Wrench |
| INCH   | MQX-3075-M10   | •   | .750       | 1.18 | .708 | M10 | 11.8        | 16 | ZPMT1003**ZER-PL<br>ZPMT1003**ZER-NL<br>ZPMT1003**ZER-SL<br>YPHW1003**Z*R**<br>YPHW100320ZER-24 | 3         | TSW-2556H | T-08   |
|        | MQX-5100-M12   | •   | 1.00       | 1.38 | .809 | M12 | 14.7        | 20 |   | 5         | DSW-2563H | T-08   |
|        | MQX-5125-M16   | •   | 1.25       | 1.69 | 1.14 | M16 | 18.4        | 25 |   | 5         |           |        |
| METRIC | MQX-2016-M8    | •   | 16         | 23   | 14   | M8  | 11.8        | 16 |   | 2         | TSW-2556H | T-08   |
|        | MQX-2017-M8    | •   | 17         | 23   | 14   | M8  | 11.8        | 16 |   | 2         |           |        |
|        | MQX-3020-M10   | •   | 20         | 30   | 18   | M10 | 11.8        | 16 |   | 3         |           |        |
|        | MQX-4020-M10   | •   | 20         | 30   | 18   | M10 | 11.8        | 16 |   | 4         |           |        |
|        | MQX-4021-M10   | •   | 21         | 30   | 18   | M10 | 11.8        | 16 |   | 4         |           |        |
|        | MQX-4025-M12   | •   | 25         | 35   | 22.5 | M12 | 14.7        | 20 | 4   |           |           |        |
|        | MQX-5025-M12   | •   | 25         | 35   | 22.5 | M12 | 14.7        | 20 | 5   | DSW-2563H | T-08      |        |
|        | MQX-4026-M12   | •   | 26         | 35   | 22.5 | M12 | 14.7        | 20 | 4   |           |           |        |
|        | MQX-5026-M12   | •   | 26         | 35   | 22.5 | M12 | 14.7        | 20 | 5   |           |           |        |
|        | MQX-5030-M16   | •   | 30         | 43   | 27   | M16 | 18.4        | 25 | 5   |           |           |        |
|        | MQX-5032-M16   | •   | 32         | 43   | 29   | M16 | 18.4        | 25 | 5   |           |           |        |
|        | MQX-6032-M16   | •   | 32         | 43   | 29   | M16 | 18.4        | 25 | 6   |           |           |        |
|        | MQX-5035-M16   | •   | 35         | 43   | 29   | M16 | 18.4        | 25 | 5   |           |           |        |
|        | MQX-6035-M16   | •   | 35         | 43   | 29   | M16 | 18.4        | 25 | 6   |           |           |        |
|        | MQX-6040-M16   | •   | 40         | 43   | 32   | M16 | 18.4        | 25 | 6   |           |           |        |
|        | MQX-7040-M16   | •   | 40         | 43   | 32   | M16 | 18.4        | 25 | 7   |           |           |        |
|        | MQX-6042-M16   | •   | 42         | 43   | 32   | M16 | 18.4        | 25 | 6   |           |           |        |

See page A-77 for Modular Head Shanks.

Note: All cutters are supplied without inserts or wrenches.



INCH

METRIC

QM Max

QXP Style

G-Body



Fig. 1

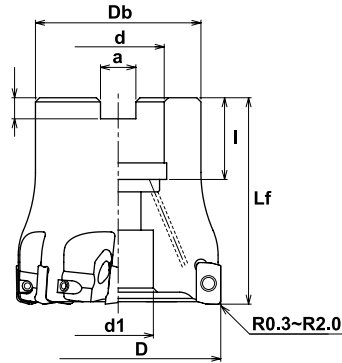
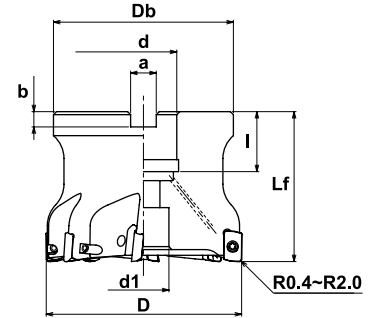

Fig. 2



Specifications - Inch

| CATALOG NUMBER | STK | DIMENSIONS |      |      |      |     |      |      |      | FIG. | INSERT   | Q | PARTS     |        |
|----------------|-----|------------|------|------|------|-----|------|------|------|------|--|---|-----------|--------|
|                |     | D          | Lf   | Db   | d    | d1  | a    | b    | l    |      |  |   | Screw     | Wrench |
| QXP-8200R-075  | •   | 2.00       | 2.00 | 1.77 | .750 | .63 | .319 | .197 | .750 | 1    | ZPMT1003**ZER-PL<br>ZPMT1003**ZER-NL<br>ZPMT1003**ZER-SL<br>YPHW100308Z*R-**<br>YPHW100320ZER-24 | 8 | DSW-2563H | T-08   |

Note: All cutters are supplied without inserts or wrenches.

Specifications - Metric

| CATALOG NUMBER | STK | DIMENSIONS |    |    |        |    |      |     |    | FIG. | INSERT   | Q | PARTS     |        |
|----------------|-----|------------|----|----|--------|----|------|-----|----|------|--|---|-----------|--------|
|                |     | D          | Lf | Db | d      | d1 | a    | b   | l  |      |  |   | Screw     | Wrench |
| QXP-6040R-16   | •   | 40         | 45 | 35 | 16     | 14 | 8.4  | 5.6 | 18 | 1    | ZPMT1003**ZER-PL<br>ZPMT1003**ZER-NL<br>ZPMT1003**ZER-SL<br>YPHW100308Z*R-**<br>YPHW100320ZER-24 | 6 | DSW-2563H | T-08   |
| QXP-7040R-16   | •   | 40         | 45 | 35 | 16     | 14 | 8.4  | 5.6 | 18 | 1    |  | 7 |           |        |
| QXP-7050R-22   | •   | 50         | 50 | 40 | 22     | 17 | 10.4 | 6.3 | 20 | 1    |  | 7 |           |        |
| QXP-8050R      | •   | 50         | 50 | 40 | 22.225 | 17 | 8.4  | 5   | 20 | 1    |  | 8 |           |        |
| QXP-8050R-22   | •   | 50         | 50 | 40 | 22     | 17 | 10.4 | 6.3 | 20 | 1    |  | 8 |           |        |
| QXP-8052R-22   | •   | 52         | 50 | 40 | 22     | 17 | 10.4 | 6.3 | 20 | 1    |  | 8 |           |        |
| QXP-8063R      | •   | 63         | 50 | 48 | 22.225 | 17 | 8.4  | 5   | 20 | 1    |  | 8 |           |        |
| QXP-8063R-22   | •   | 63         | 50 | 48 | 22     | 17 | 10.4 | 6.3 | 20 | 1    |  | 8 |           |        |
| QXP-8066R      | •   | 66         | 50 | 60 | 22.225 | 17 | 8.4  | 5   | 20 | 2    |  | 8 |           |        |
| QXP-8066R-27   | •   | 66         | 50 | 48 | 27     | 20 | 12.4 | 7   | 22 | 2    | 8  |   |           |        |

Note: All cutters are supplied without inserts or wrenches.