



# QM Max GII

## Max Master



- Double sided high feed insert with 4 cutting edges.
- Low cutting force with optimum cutting edge.
- New strong PH chipbreaker insert is excellent in fracture resistant and applicable to heavy applications.
- Excellent in ramping, helical interpolation and high efficient pocket milling.
- G-body is a GN surface-hardening treatment on thermal resistant high strength steel giving a hardness over 65 HRC and secures insert pocket and holder against thermal deformation improving body durability.



**INCH**

**METRIC**

**MODULAR HEAD**  
MXG Type - coolant thru

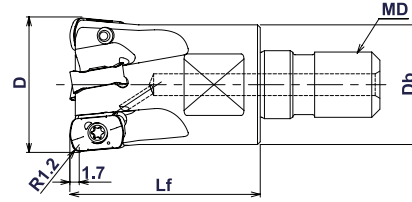
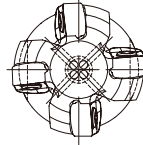

**Specifications**

	CATALOG NUMBER	STK	DIMENSIONS				Q	Head Torque		INSERT	PARTS	
			D	Lf	Db	MD		lbs/ft	Nm		Screw	Wrench
<b>INCH</b>	MXG-2062-M8	•	.625	.905	.551	M8	2	11.8	16	ENMU100412ZER-**	TSW-2567H	T-08
	MXG-3075-M10	•	.750	1.18	.708	M10	3	11.8	16			
	MXG-3100-M12	•	1.00	1.38	.866	M12	3	14.7	20			
	MXG-4100-M12	•	1.00	1.38	.866	M12	4	14.7	20			
	MXG-5125-M16	•	1.25	1.69	1.14	M16	5	18.4	25			
	MXG-6150-M16	•	1.50	1.69	1.14	M16	6	18.4	25			
<b>METRIC</b>	MXG-2016-M8	•	16	23	14	M8	2	11.8	16			
	MXG-2017-M8	•	17	23	14	M8	2	11.8	16			
	MXG-3020-M10	•	20	30	18	M10	3	11.8	16			
	MXG-3021-M10	•	21	30	18	M10	3	11.8	16			
	MXG-3025-M12	•	25	35	22	M12	3	14.7	20			
	MXG-4025-M12	•	25	35	22	M12	4	14.7	20			
	MXG-4026-M12	•	26	35	22.5	M12	4	14.7	20			
	MXG-5030-M16	•	30	43	27	M16	5	18.4	25			
	MXG-5032-M16	•	32	43	29	M16	5	18.4	25			
	MXG-5035-M16	•	35	43	29	M16	5	18.4	25			
	MXG-6040-M16	•	40	43	32	M16	6	18.4	25			
	MXG-6042-M16	o	42	43	32	M16	6	18.4	25			

o - longer delivery may apply.  
See page A-59 for Modular Head Shanks.

Note: All cutters are supplied without inserts or wrenches.

**INSERTS**

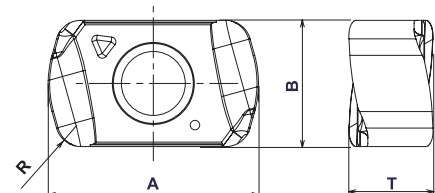
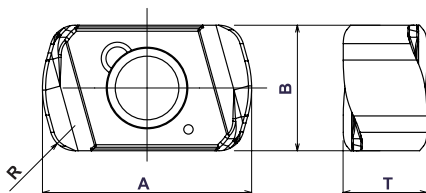

CATALOG NUMBER	TOLERANCE	DIMENSIONS				PVD COATED		
		A	B	T	R	JC7550	JC8118	JC7560
ENMU100412ZER-PH	M	10	6	4	1.2		•	•
ENMU100412ZER-SL	M	10	6	4	1.2	•		