



SKS GII-09 High Feed

INCH

METRIC

SKG-09 Face Mills & Modular Heads

For heat resistant alloys, titanium alloy & hardened stainless steel.
SKG-09 & MSG-09 Style

G-Body

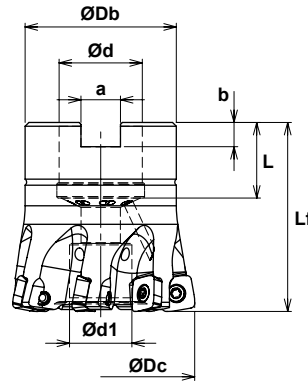

Face Mill Specifications

	CATALOG NUMBER	STK	DIMENSIONS							INSERT	Q	PARTS		
			ØDc	Lf	ØDb	Ød	Ød1	a	b			L	Screw	Wrench
INCH	SKG-7200R-09-075	•	2.00	2.00	1.77	.750	.590	.319	.197	.750	SDEW090312ZER SDET090312ZDER-SM	7	DSW-307H	T-10
	SKG-8250R-09-075	•	2.50	2.00	1.89	.750	.669	.319	.197	.750		8		
	SKG-9300R-09-100	•	3.00	2.00	2.21	1.00	.787	.374	.236	.945		9		
	SKG-9300R-09-125	•	3.00	2.00	2.68	1.25	1.02	.500	.315	.945		9		
METRIC	SKG-5040R-09-16	•	40	40	37	16	13.5	8.4	5.6	18		5		
	SKG-7050R-09-22	•	50	50	40	22	16.5	10.4	6.3	20		7		
	SKG-7052R-09-22	◦	52	50	40	22	16.5	10.4	6.3	20		7		
	SKG-8063R-09-22	•	63	50	48	22	17	10.4	6.3	20		8		
	SKG-8066R-09-27	◦	66	50	50	27	20	12.4	7	22		8		
SKG-9080R-09-27	•	80	50	60	27	20	12.4	7	22	9				

Note: All cutters are supplied without inserts or wrenches.

G-Body

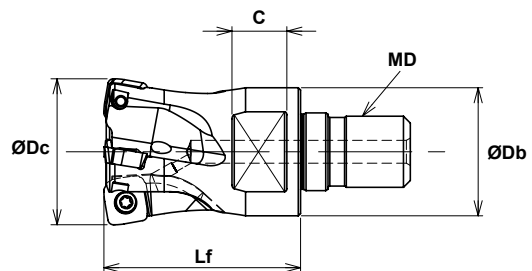
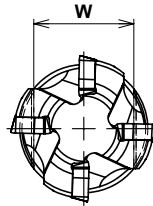

Modular Head Specifications

	CATALOG NUMBER	STK	DIMENSIONS					INSERT	Q	PARTS		
			ØDc	Lf	ØDb	MD	C			W	Screw	Wrench
INCH	MSG-3100-09-M12	•	1.00	1.38	.905	M12	11	19	SDEW090312ZER SDET090312ZDER-SM	3	DSW-307H	T-10
	MSG-4125-09-M16	•	1.25	1.69	1.10	M16	12	22		4		
	MSG-5150-09-M16	•	1.50	1.69	1.26	M16	12	22		5		
METRIC	MSG-3025-09-M12	•	25	35	23	M12	11	19		3		
	MSG-4028-09-M12	•	28	35	23.6	M12	11	19		4		
	MSG-4032-09-M16	•	32	43	28	M16	12	22		4		
	MSG-5035-09-M16	•	35	43	29	M16	12	22		5		
	MSG-5040-09-M16	•	40	43	32	M16	14	26		5		
MSG-5042-09-M16	◦	42	43	32	M16	14	26	5				

◦ - longer delivery may apply.

Note: All cutters are supplied without inserts or wrenches.