



Swing Ball

High Productivity Indexable Ball Nose End Mill



- Double insert ball nose rougher.
- Positive style insert with chip breaker and larger sizes with notched edges allow smoother cutting action.
- Inserts available with negative edge prep are designed to machine hard welds.
- Able to take aggressive cuts and withstand heavy impact.



Swing Ball

INCH
METRIC

MODULAR HEADS MSW Type

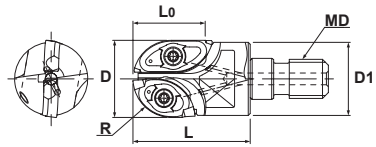

Specifications - Modular Heads - Inch

CATALOG NUMBER	STK	DIMENSIONS						HEAD TORQUE lbs./ft	INSERT	PARTS	
		D	R	L	L0	D1	MD			Screw	Wrench
MSW-2075-M10	•	.750	.375	1.18	.700	.728	M10	11.8	SWB2075HME (1) SWB2075HSE (1)	DSW-307H	T-10SD
MSW-2100-M12	•	1.00	.500	1.38	.860	.940	M12	14.7	SWB2100HME (1) SWB2100HSE (1)	DSW-4085	A-15T
MSW-2125-M16	•	1.25	.625	1.69	1.10	1.14	M16	18.4	SWB2125HME (1) SWB2125HSE (1)	DSW-509	A-20

Note: All cutters are supplied without inserts.

Specifications - Modular Heads - Metric

CATALOG NUMBER	STK	DIMENSIONS						HEAD TORQUE Nm	INSERT	PARTS	
		D	R	L	L0	D1	MD			Screw	Wrench
MSW-3225-M16	•	32	16	43	29.5	29.9	M16	25	SWB232HM-G (1) SWB232HS-G (1)	TSW-511	A-20

Note: Modular Head Holders on page 109.

Note: All cutters are supplied without inserts.

May also use inserts for welds or hardened material.

END CAP SWB-EC Style

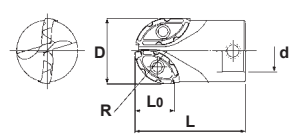

Specifications - End Cap

CATALOG NUMBER	STK	DIMENSIONS								INSERT	PARTS	
		D	R	L	L0	I1	I3	d	θ		Screw	Wrench
SWB-2200-EC	•	2.0"	1.0"	3.38"	1.18"	-	-	1.25"	-	SWB2200HMNE (1) SWB2200HSNE (1)	HSW-614H ECS-0030	T-30 A-316

Note: All cutters are supplied without inserts.